

# PHOTOELECTRIC SMOKE DETECTOR

## INTRODUCTION

This product runs by detecting smoke particles. With special structure designed, photoelectric signal processing technique, dustproof, mothproof and anti-light interference functions, the stability of the detector is warranted from design. It performs good in detecting visible smoke caused by hidden or bright fire. Suitable for houses, emporiums, hotels and storages etc.

## GENERAL VIEW

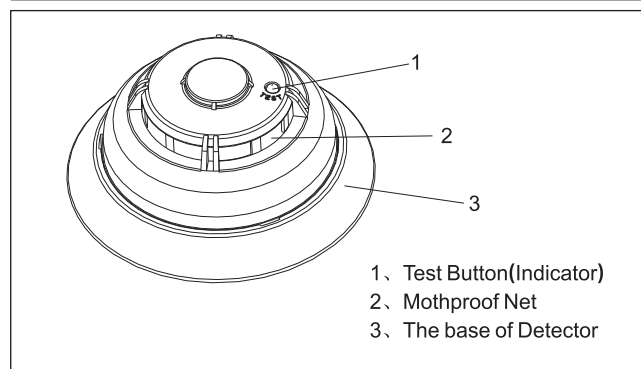

## TECHNICAL SPECIFICATIONS

Supply voltage	DC 9V
Standby current	≤30uA
Alarm current	≤30mA
Operating temperature	-10℃-50℃
Operating humidity	≤95%RH
Mounting method	Ceiling mounted
Detecting range	20m <sup>2</sup>
LED Frequency	One time per 40 seconds
Output pattern	Sound&Light/wireless signal output (868MHz)
Sensor type	Infrared photoelectric diode
Sensitivity	I degree
Low V <sub>DD</sub> alarm threshold	7.5V

## INSTALLATION

1. Please install the battery as required.
2. Choose a suitable position (normally mounted in the center of the detecting area on the ceiling) and mount the detector base on the selected position by screws, then push the detector into the base and rotate it to check it is firm or not.

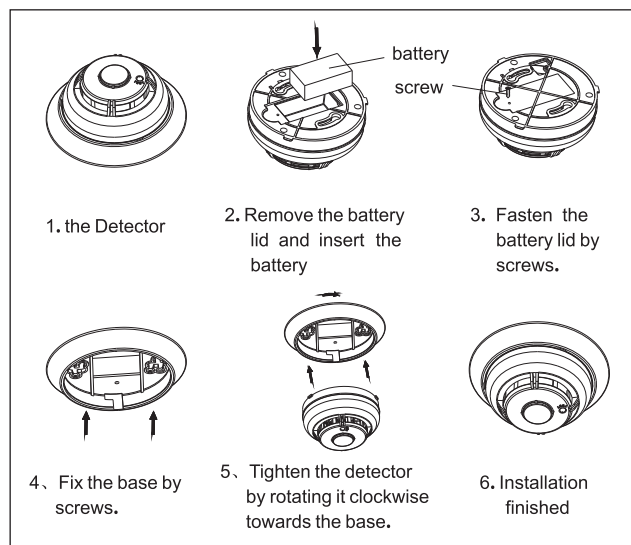

## TESTING

1. With the power supply, the detector turns into normal detecting state immediately, then the LED flashes one time per 40 seconds.
2. Push the test button down, then the indicator LED flashes one time per second and the buzzer sounds "Di-Di-Di", meanwhile the wireless signal is sent out. You can also blow directly a little smoke into the detector to test the performance of this product. The detector will resume into normal detecting state when the smoke dispelled.

## NOTICES

1. The product should not be installed in extreme hot or cold, or high wind speed surroundings and in the conditions where there is often a lot of smoke or dust.
2. The detector needs to be tested one time every month.
3. To ensure its normal performance, please clean the detector surface with soft brush one time half a year. Do cut off the power before cleaning.
4. If the detector is found to be defective, do not attempt to disassemble it. Please contact the After Service Center or the distributor for professional servicing.
5. This product can reduce the possibility of accidents, but it can not guarantee absolute safety due to various factors, including, but not limited to, changes in environmental conditions, electric or electronic disruptions and tampering. The user is advised to take all necessary precautions for safety and enhance safety consciousness in daily life.